



FUELAB



Welcome to the Digital Age! **2017**

PRODUCT CATALOG

www.FUELAB.com

FUELAB PRODIGY FUEL PUMPS

THE REASON BEHIND THE TECHNOLOGY

The most common failure of high flow fuel systems is cavitation related to vapor lock. The combination of too much heat or too much inlet restriction can create this operating condition, where the liquid fuel literally vaporizes (boils) inside the pump assembly. Symptoms can include a dramatic loss of flow rate, gauge "bouncing", grinding and excessive noise from the pump, and inconsistent or loss of fuel pressure.

As bad as the symptoms of this condition are, the results are often permanent, even if what caused the condition in the first place is fixed. This damage results in a direct loss of capacity and efficiency. Often as noted when unchecked, this damage to the pump results in operating conditions that quicken cavitation exposure at each use. Eventually the fuel system resorts to complete failure to build or maintain pressure. Loss of fuel delivery pressure will also result in an engine lean out condition that can result in engine damage.

While limitations on using racing components on street driven vehicles is nothing new, some still mistakenly believe that a large racing electric pump can be used at full continuous speed. Aftermarket high performance fuel pumps are susceptible to creating vapor lock conditions due to the amount of flow and pressure requirements put on the pumps in a continuous duty operating condition.

OUR SOLUTION

Fuelab Prodigy fuel pumps use a DC brushless motor system. The pump contains electronics that control the pump's operation. Prodigy pumps use an input signal to determine the desired operating speed. By having this feature, pump speed becomes controllable, allowing continuous duty applications for high flow pumps and avoiding a full speed high current draw condition that leads to heat buildup and the potential for vapor lock. Prodigy does this without expensive control boxes or voltage reducing devices.

Wiring for the speed control is easy. Our third terminal for speed control, shown in the picture on the left, can be wired in multiple ways. If the terminal sees a ground (or zero volts), then Prodigy knows to operate at a predetermined reduced speed mode (typically still supporting several hundred horsepower) for continuous duty mode. If the terminal sees high voltage condition (such as applying 12 volts), then Prodigy knows to operate at full speed mode. Some aftermarket ECMs that output a variable dwell time signal at 1000Hz can also be programmed to give a full variable speed control as well. Connect this terminal to our 529xx Series Electronic Fuel Pressure Regulator, and enjoy automatic demand control, giving you "OEM" style low current draw while idling, while still capable of leaping to full speed, feeding the most demanding of applications, including drag racing.



PRODIGY FUEL PUMPS

▼ COLOR OPTIONS - C

Actual colors may vary.

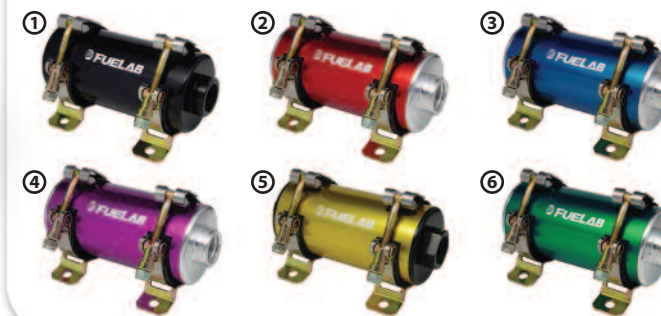

At FUELAB, we are constantly developing not only new products – but new ways of thinking. Our Prodigy line of fuel pumps were born of inspiration and innovation, and our DC brushless technology stands alone as the benchmark in demand based fuel delivery systems. Our 15+ years of experience in fuel delivery systems gives us the knowledge and experience to provide our customers with cutting edge products that take fuel delivery to a whole new level. Each Prodigy pump is hand built and tested at our facility in Collinsville, IL under strict quality and rigorous testing guidelines before shipping. This allows us to give our customers the confidence and competitive edge we know you are looking for and expect from a manufacturer. We have 8 innovative models available ranging in performance levels; with flow rates up to 200GPH and operating pressures up to 125PSI. Please take a moment to review our catalog, and let us know what you think!

75GPH @ 45PSI **40401** **RATED UP TO 700HP**
Model 40401 reduced size EFI In-Line Fuel Pump
 All the great features of our original Prodigy series in a smaller package! Get the benefits of a 255lph rated fuel pump with less current draw and cross fuel compatibility all in a pure billet format.

160GPH @ 15PSI **40402** **RATED UP TO 800HP**
Model 40402 reduced size Carbureted In-Line Fuel Pump
 This 200GPH free flow rating fuel pump is programmed to deliver the maximum flow with the lowest current draw available. Nothing else like it!

105 GPH @ 45 PSI **41401** **RATED UP TO 1000HP**
Model 41401 High Pressure EFI In Line Fuel Pump
 The original digital Prodigy fuel pump, great for racing, performance, or off-road use.

140 GPH @ 45 PSI **41402** **RATED UP TO 1300HP**
Model 41402 High Efficiency EFI In Line Fuel Pump
 Increase performance capabilities with extra flow for higher powered engines.

200 GPH @ 20 PSI **41403** **RATED UP TO 1800HP**
Model 41403 Carbureted In-Line Fuel Pump
 Get a high amount of flow with this pump made for carbureted and lower pressure applications.

200 GPH @ 20 PSI **41404** **RATED UP TO 1800HP**
Model 41404 Carbureted In-Line Fuel Pump
 Developed from our successful 41403 model, we take all the benefits of a high flow in-line pump and integrate a bypass valve directly into the outlet assembly of the pump.

170 GPH @ 45 PSI **42401** **RATED UP TO 1500HP**
Model 42401 High Pressure EFI In-Line Fuel Pump
 Throw in as much boost as you want, this model will support up to 1500 horsepower at high pressures.

190 GPH @ 45 PSI **42402** **RATED UP TO 1800HP**
Model 42402 High Power EFI In-Line Fuel Pump
 The top of the line... supports very high horsepower!



ELECTRONIC FPR

PRODIGY FUEL PUMPS

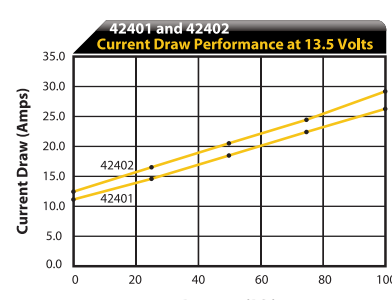
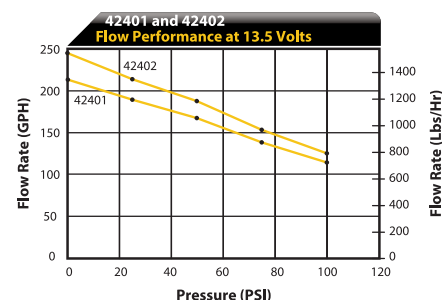
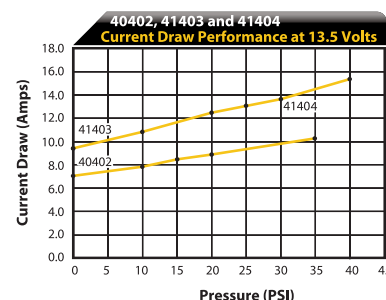
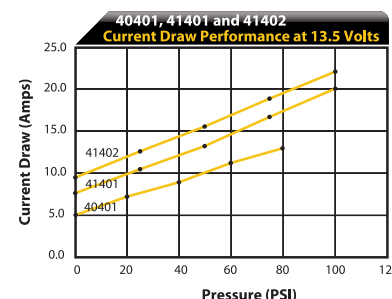
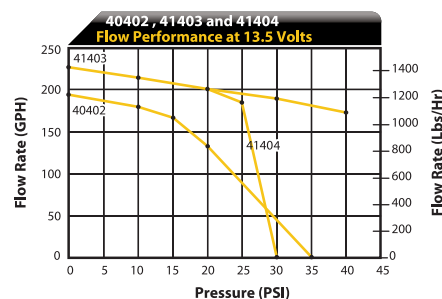
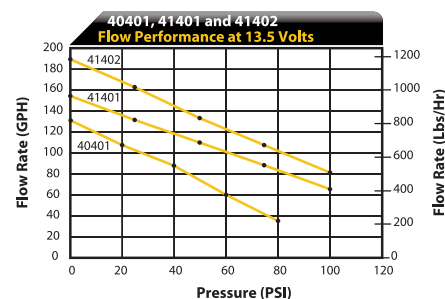

PUMP FEATURES:

- Compatible with gasoline, diesel, methanol, and ethanol
- High efficiency sling vane positive displacement pump
- Special housing shape for extremely quiet operation and steady pressure
- Carbon 9-vane construction with pressure balanced rotor for high reliability
- Backed by a 2-year limited warranty

MOTOR FEATURES:

- Lightweight super-efficient dc brushless motor reduces current draw
- Low mass rotor for high speed reaction to changes in speed and flow
- Powerful high flux density Neodymium rare earth magnets
- No motor brushes to wear out or corrode (low-Sulfur diesel, no problem)
- Wet motor design, no dynamic shaft seals that can wear

ELECTRONIC FEATURES:

- Internal speed controller for variable flow operation
- Accepts PWM input for speed control
- 12 to 16 volt vehicle electrical system compatibility
- No expensive voltage reduction/pulse width modulation controllers required
- Continuous duty motor speed can be adjusted to meet fuel demand

CONSTRUCTION FEATURES:

- Compact, lightweight design, less than 2.5lbs!
- Billet Aluminum Construction with anodize per MIL-A-8625, Type II
- High quality mounting brackets included
- Long-life, multi-fuel compatible Fluorosilicone static seals
- Accepts standard or port style -10AN fittings

ALL PRODIGY FUEL PUMPS ARE GASOLINE, DIESEL, METHANOL, AND ETHANOL COMPATIBLE. NOW YOU CAN SUPPORT BIG POWER WITHOUT A BELT DRIVEN PUMP.

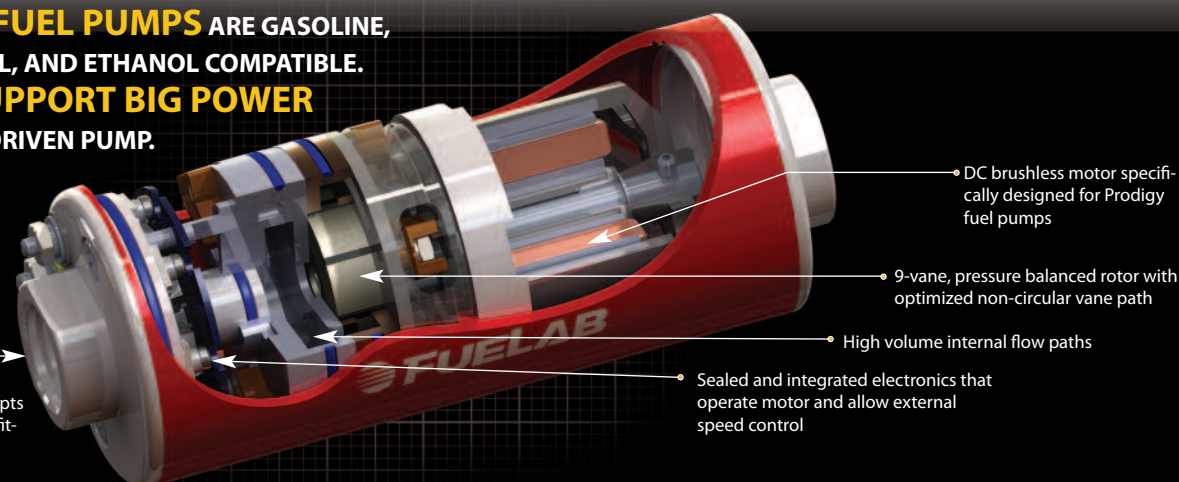

TAKE THE GUESS WORK OUT OF FUEL DELIVERY!

Our electronic fuel pressure regulator works directly with our Prodigy line of fuel pumps to reduce heat build up and vapor lock conditions. Set the pressure mechanically like a traditional bypass regulator, then let the electronic regulator's demand based speed control take care of the rest! The Fuelab electronic fuel pressure regulator generates a signal to the Prodigy pump, to control the return line flow rate. This feature reduces current draw while at low engine output, to prevent fuel overheating that leads to fuel system failure. With the FUELAB demand based system, true pump control is finally achievable and easy to install!

FEATURES:

- Works with Fuelab's Prodigy Fuel Pumps.
- Patented method for demand based flow control, able to detect changes in demand before change in rail pressure is realized. U.S. Patent 7,810,470
- Automatically reduces current draw at low flow demand.
- Monitoring capability to track actual fuel system capacity.
- Get the quick response of a mechanically regulated system, with the advantage of electronic flow control.
- Independent system, no other connections, control boxes or calibration required.



529xx IN-LINE REGULATOR

- On demand fuel delivery made easy!
- Fittings Included
- Wiring Harness Included

Product No.	Inlet	Seat Size	Pressure Range
52901-C	-6AN	Standard	EFI 25-90 PSID
52902-C	-8AN	Standard	EFI 25-90 PSID
52903-C-P	-6AN	Standard	Custom
52904-C-P	-8AN	Standard	Custom

Pressure Range

- T 15-25 PSID (approximate)
- E 25-90 PSID (approximate)
- G 90-125 PSID (approximate)

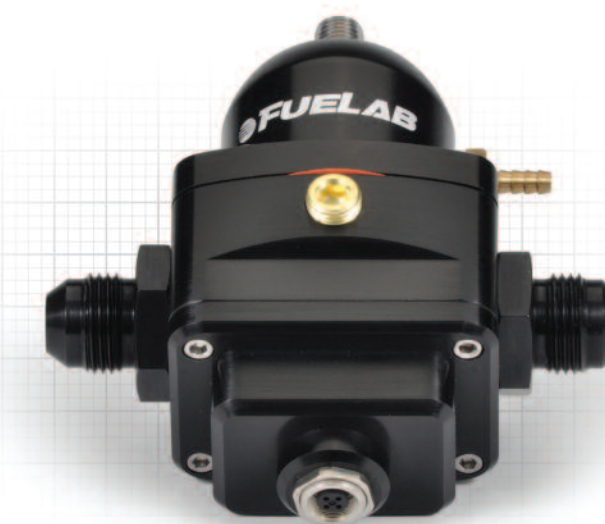

COLOR OPTIONS - C

COVER COLOR	BODY COLOR
1. Black	Black
2. Red	Clear
3. Blue	Clear
4. Purple	Clear
5. Gold	Black
6. Green	Clear

PRODIGY IN TANK POWER MODULES

It's as easy as 1-2-3!

These in-tank fuel systems bring our popular external fuel pump technology inside the fuel tank, easier than ever before. Developed for racing, these fuel systems can provide fuel for up to 1800HP. Power Modules, like all Prodigy Fuel Pumps, are compatible with Gasoline, E85, Methanol or Diesel Fuels. Power Modules can be coupled with Fuelab's Electronic Fuel pressure Regulator, bringing high flow capacity with automatic demand speed control (no programming, calibration or additional control boxes required).

Our Power Modules work with our unique sealed flange system for fabricators and vehicle specific applications. These flanges allow for installation of the Power Module into steel or aluminum tanks, fuel cells and factory stock fuel tanks. This system enables quicker installation, with quick and easy service access.

No more patching and strapping multiple pumps together on a hanger. No more splicing tee fittings, hoses and wires inside your tank. No more potential engine damage if a pump in a multi-pump set up fails. Each Power Module includes auxiliary outlets for optional use of jet pumps. Jet pumps allow transfers of fuel within the fuel tank, for tough situations such as saddle tanks or internal sumps and baffles.

The Power Module system also provides a cleaner installation by hiding the straining filter and pump. Installation time is quicker and more affordable, with less fuel system components to mount. Vehicles previously considered problematic because they are hard to sump, have saddle tanks or otherwise do not have enough room or a good location available for an external pump, now have a viable, simple and reliable solution.

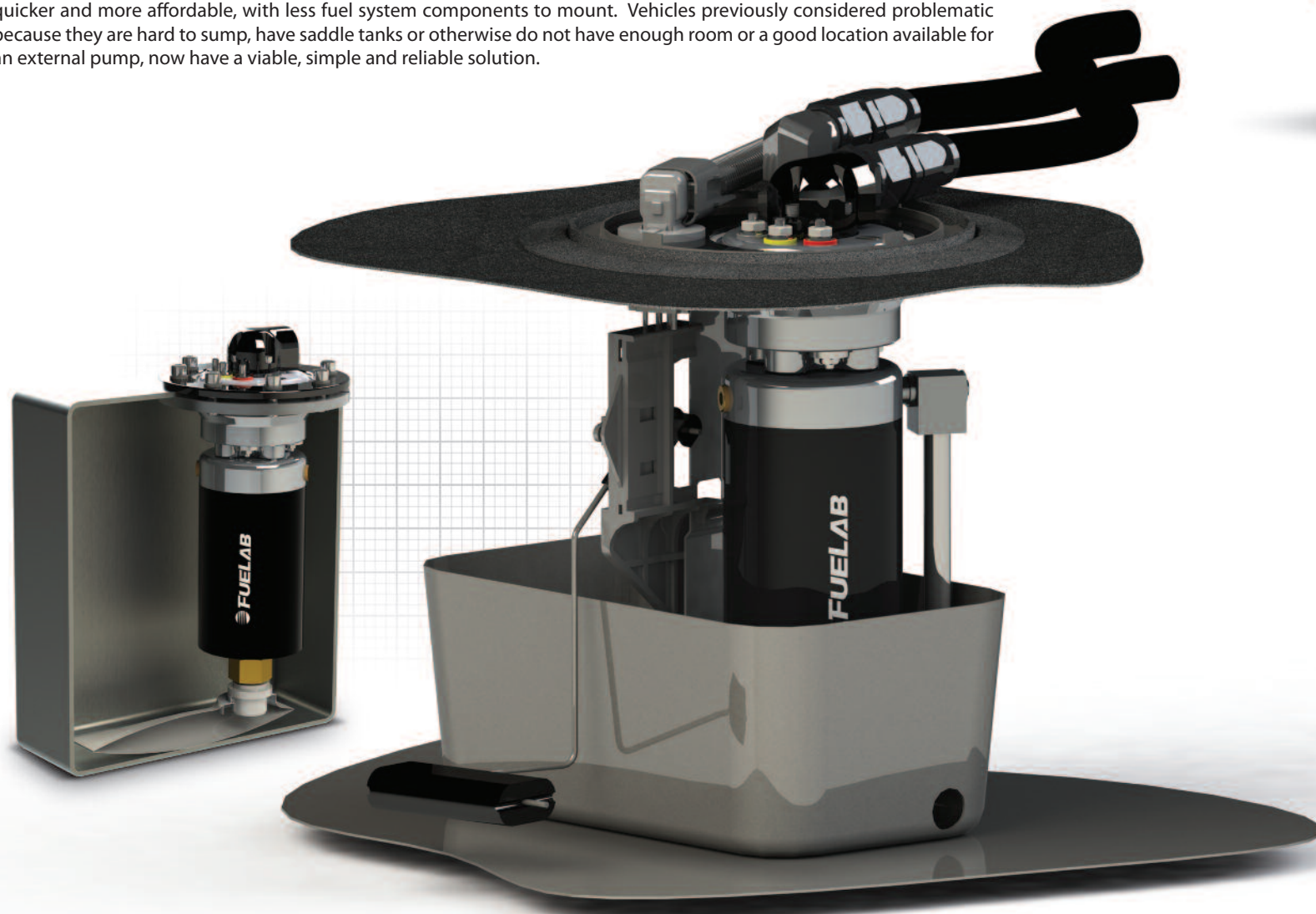

PRODIGY IN TANK POWER MODULES

**STEP 1
CHOOSE YOUR POWER**

Prodigy In-Tank Power Modules are the ultimate in upgraded fuel system components. Developed for racing, these fuel systems are designed for quick, easy installation into your factory tank or aftermarket fuel cell. Our single pump design supports up to 1800HP, increases reliability by eliminating multi pump configurations, and saves you time and money. By pairing this design with our award winning 529 series electronic fuel pressure regulator, you get high flow capacity with on demand fuel delivery, for the most advanced fuel delivery systems available.

POWER MODULE 90902 800HP
Model 90902 In Tank
Based on our popular 40402 series, but in a new configuration for in tank applications.

POWER MODULE 91901 1000HP
Model 91901 In Tank
Based on our popular 41401 series, but in a new configuration for in tank applications.

POWER MODULE 92902 1800HP
Model 92902 In Tank
Based on our popular 42402 series, but in a new configuration for in tank applications.

PUMP FEATURES:

- Based on our popular Prodigy Series, but in a new configuration for in-tank applications
- Compatible with gasoline, diesel, methanol and ethanol
- Jet pump compatibility for saddle tanks or internal pumps
- High efficiency sling vane positive displacement pump
- Special housing shape for extremely quiet operation and steady pressure
- Carbon 9-vane construction with pressure balanced rotor for high reliability
- Backed by 2 year limited warranty

ELECTRONIC FEATURES:

- Internal Speed controller for variable flow operation
- 12 to 16 volt vehicle electrical system compatibility
- Accepts PWM input for speed control
- No expensive add-on voltage regulators or pump controllers required
- Continuous duty motor speed can be adjusted to meet fuel demand

MOTOR FEATURES:

- Lightweight super efficient DC brushless motor reduces current draw
- Low mass rotor for high speed reaction to changes in speed and flow
- Powerful high flux density neodymium rare earth magnets
- No motor brushes to wear out or corrode (low sulfur diesel, no problem)
- Wet motor design, no dynamic shaft seals that can wear out

INSTALLATION FEATURES:

- Requires the use of a bypass style regulator and return line
- Single Drop in Fuel Pump
- Installation kits available for Fabricator Series and Vehicle Specific Applications
- No wires to pass in fuel tanks
- Eliminates the need for multi-pump wiring, Y-blocks, and extra plumbing
- Retains OEM level sensor and connector
- Easy service access flange system
- Installation kits sold separately
- Utilizes the factory tank, o-ring, lock ring and mounting location
- Can be used without 529 Series Electronic Fuel Pressure Regulator
- Features Noise Dampening Pump Mount Technology

POWER MODULE INSTALL KITS - **STEP 2** CHOOSE YOUR INSTALL

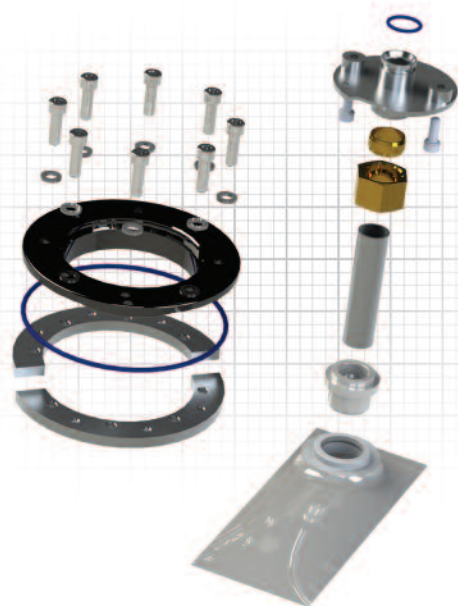

Designed for the custom tank builder or fabricator, the new FUELAB In-Tank Power Modules work with our unique sealed flange system to give you multiple mounting options into steel or aluminum tanks and fuel cells. The Power Module system also provides a cleaner installation by hiding the straining filter and pump. Installation time is quicker and more affordable, with less fuel system components that require mounting. Previously considered problematic vehicles that are hard to sump, have saddle tanks or otherwise do not have enough room or a good location available for an external pump, now have a viable, simple and reliable solution.

PRODUCT FEATURES:

- Fabricator Series allows installation into steel or aluminum tanks and fuel cells using a unique sealed flange system
- Installation requires the use of a Fuelab Power Module (available separately).
- Includes an adjustable pickup with 75 micron integrated stainless steel filter sock
- Requires the use of a bypass style regulator and return line
- Single Drop in Fuel Pump

20901 **KIT**

In Tank Power Module Fabricator Installation Kit
• Aluminum Assembled Flange Fabricator Kit

20902 **KIT**

In Tank Power Module Fabricator Installation Kit
• Aluminum Weldable Flange Fabricator Kit

20903 **KIT**

In Tank Power Module Fabricator Installation Kit
• 18-8 Stainless Steel Weldable Flange Fabricator Kit

These kits are designed to work with 2005-2009 Mustangs. No cutting or fabrication is required to allow truly high flow capability without having to resort to expensive multi-pump hanger systems with multiple wires and tees. These installation kits allow a direct installation into the OE Mustang's fuel tank as well as the implementation of a superior rock-steady pressure return-style fuel system. System can be used for continuous duty or racing applications. Included with this kit is a Billet Jet Pump that allows direct plug-in to the factory's internal plumbing. This system draws fuel from the passenger side portion of the saddle tank. These kits allow for the use of the original OE Module's sub-components for the fuel tank fuel level sensor and connector that easily swaps over. Because of the superior performance of Fuelab's speed control technology, you don't have to worry about tricks such as bending the factory's fuel level sensor to fool the driver into keeping more fuel in the tank to prevent cavitation.

PRODUCT FEATURES:

- Fits 2005-2009 Mustangs (S197)
- Incorporates OE Fuel Pump Module wiring connector and sending unit
- Includes an integrated 75 micron stainless steel filter sock
- Single Drop in Fuel Pump
- Seals with Factory o-ring and lock ring
- -8AN Outlet and -8AN return port
- Other more complete kits are available for the 2005-2009 Mustangs.
- Installation requires the use of a Fuelab Power Module (available separately).
- Additional plumbing and electrical items are required for a more complete installation, including return line and independent electrical power system (available separately per Model 21911).
- Software changes are required for ECM to switch to "Return Style Fuel System" from the original "Returnless Style Fuel System" setting.
- Addition of return style regulator is required (available separately).

RECOMMENDED PRODUCT:

- 21911 FUELAB Mustang 2005-2009 Wiring/Plumbing Kit (listed on next page)

20911 **KIT**

In Tank Power Module
• Mustang Install Kit
• Fits 2005-2009 Mustangs

20912 **KIT**

In Tank Power Module
• Mustang GT 500 Install Kit
• Fits 2007-2009 GT 500 Mustangs

INSTALLATION KITS AND PACKAGES

STEP 3 WIRING AND PLUMBING

This installation kit works in conjunction with either the 20911 or 20912 Power Module Installation Kits for 2005-2009 Mustangs. This kit allows an even easier modification and installation of Fuelab Power Modules for the Mustang, making it easier to install without the hassles of sourcing wiring, relay, fuel lines and attachment clamps. By having this kit, you can reduce time and guesswork that are normally associated with extensive vehicle fuel system modifications.

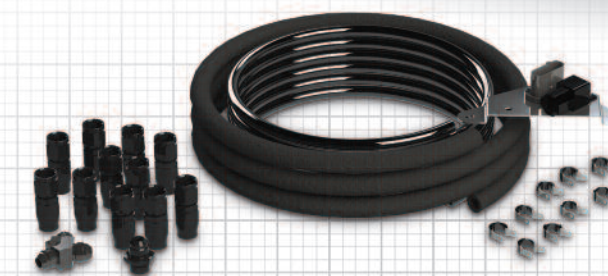

21911 **KIT**

FUELAB Mustang S197 Plumbing and Electrical Installation Kit 2005-2009

229xx **TOTAL FUEL SYSTEM PACKAGE**

FUELAB TOTAL Fuel System Package

This is the Complete Installation Kit that every 2005-2009 Mustang needs! The TOTAL Fuel System Package. This installation kit includes all that you need to install a truly high flow advanced fuel system capable of both continuous duty and racing applications. This installation kit not only includes Fuelab's most advanced billet in-tank pump system along with approved wiring and plumbing, but includes the most intelligent and award winning regulator on the market: The Fuelab Electronic Regulator. The Fuelab 529xx Series electronic regulator automatically controls the Fuelab pump to minimize operation based on actual measured fuel demand. These Total Fuel System Packages allow for all plumbing from the OE fuel tank to your Aftermarket -8AN Fuel rails (not included in this Kit), for a complete return-style AN Billet Fuel System.

22911/1000HP PACKAGE INCLUDES:

- 91901 Fuelab 1000 HP Power Module
- 20911 Fuelab 2005-2009 Mustang Installation Kit
- 21911 Fuelab 2005-2009 Mustang Plumbing and Electrical Installation Kit
- 52902 Fuelab Electronic Fuel Pressure Regulator
- 82802 Fuel Filter
- Use on 2005-2009 Mustangs that have the OE Single Pump system.

22912/1000HP PACKAGE INCLUDES:

- 91901 Fuelab 1000 HP Power Module
- 20912 Fuelab 2007-2009 GT500 Mustang Installation Kit
- 21911 Fuelab 2005-2009 Mustang Plumbing and Electrical Installation Kit
- 52902 Fuelab Electronic Fuel Pressure Regulator
- 82802 Fuel Filter

22913/1800HP PACKAGE INCLUDES:

- 92902 Fuelab 1800 HP Module
- 20911 Fuelab 2005-2009 Mustang Install Kit
- 21911 Fuelab 2005-2009 Mustang Plumbing and Electrical Installation Kit
- 52902 Fuelab Electronic Fuel Pressure Regulator
- 82802 Fuel Filter
- Use on 2005-2009 Mustangs that have the OE Single Pump system.

22914/1800HP PACKAGE INCLUDES:

- 92902 Fuelab 1800 HP Module
- 20912 Fuelab 2007-2009 GT500 Mustang Installation Kit
- 21911 Fuelab 2005-2009 Mustang Plumbing and Electrical Installation Kit
- 52902 Fuelab Electronic Fuel Pressure Regulator
- 82802 Fuel Filter

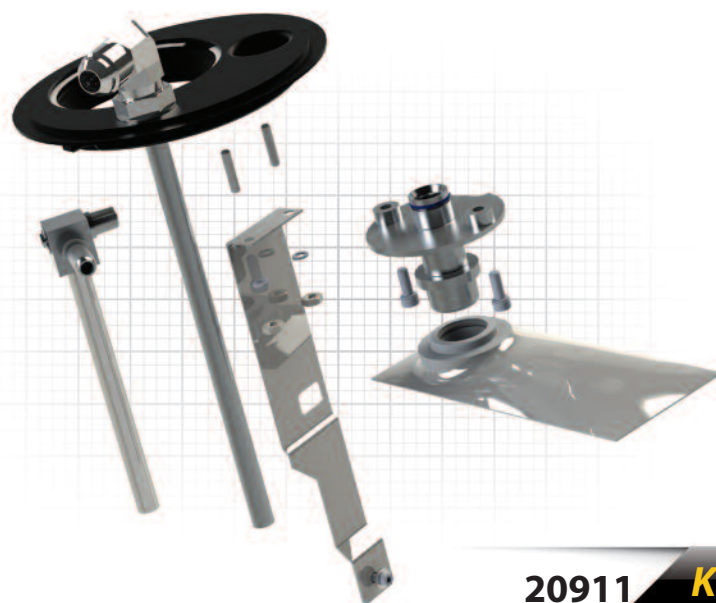

FUEL PRESSURE REGULATORS

FUELAB® 515/525 Series Fuel Pressure Regulators are designed with performance and flexibility in mind. They accept port style and non-port style union fittings without interference. Several configurations are available, supporting carbureted applications as low as 1 PSID to fuel injected applications up to 125 PSID. The 515 Series Fuel Pressure Regulator has a -6AN return port located on the bottom. The 525 Series has its return port in-line with the inlet port (not on the bottom) which allows for easy installation in extremely tight locations.

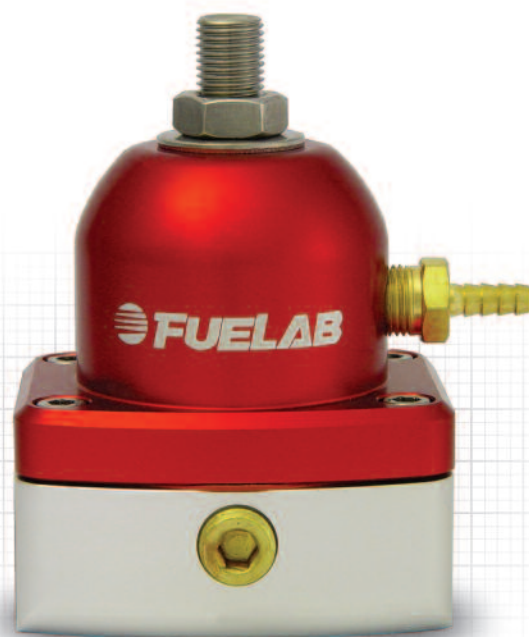

FEATURES:

- Gasoline, diesel, methanol, and ethanol fuel compatible
- Billet Aluminum with anodize per military MIL-A-8625, Type II
- Fine thread pitch for precise pressure adjustment
- Versatile mounting bracket and stainless steel hardware
- 1/8" NPT gauge port with plug for external pressure gauge
- 1/8" NPT pressure reference port with barbed fitting
- Backed by a 2-year limited warranty

PRESSURE OPTIONS:

For a custom Fuel Pressure Regulator please refer to these options and select (S) Seat Size and (P) Pressure Range.

Seat Size

- S** Standard seat (return orifice)
- L** Large seat (return orifice)

Pressure Range

- L** 1-3 PSID (approximate)
- C** 4-12 PSID (approximate)
- T** 10-25 PSID (approximate)
- E** 25-90 PSID (approximate)
- G** 90-125 PSID (approximate)

HIGH HORSEPOWER 515xx REGULATOR

- Two -6AN or -10AN inlet and one -6AN return port

Product No.	Inlet	Seat Size	Pressure Range
51501-C	-10AN	Standard	EFI 25-90 PSID
51502-C	-6AN	Standard	EFI 25-90 PSID
51503-C	-10AN	Large	CARB 4-12 PSID
51504-C	-6AN	Large	CARB 4-12 PSID
51505-C-S-P	-10AN	Custom	Custom
51506-C-S-P	-6AN	Custom	Custom

EASY FIT REGULATOR 525xx IN-LINE REGULATOR

- Easy installation in extremely tight locations
- -6AN inlet and -6AN return port in-line

Product No.	Inlet	Seat Size	Pressure Range
52501-C	-6AN	Standard	EFI 25-90 PSID
52502-C	-6AN	Large	CARB 4-12 PSID
52503-C-S-P	-6AN	Custom	Custom

COLOR OPTIONS - C

Actual colors may vary.



COVER COLOR	BODY COLOR
1. Black	Black
2. Red	Clear
3. Blue	Clear
4. Purple	Clear
5. Gold	Black
6. Green	Clear

MINI-REGULATORS

FUELAB® 535/545 Series Fuel Pressure Regulators have all the same great features as our 515/525 series, only smaller and weigh 50% less. They accept port style and non-port style union fittings without interference. Several configurations are available, supporting carbureted applications as low as 10 PSID to fuel injected applications up to 125 PSID. The 535 Series Fuel Pressure Regulator has a -6AN return port located on the bottom. The 545 Series has its return port in-line with the inlet port (not on the bottom) which allows for easy installation in extremely tight locations.

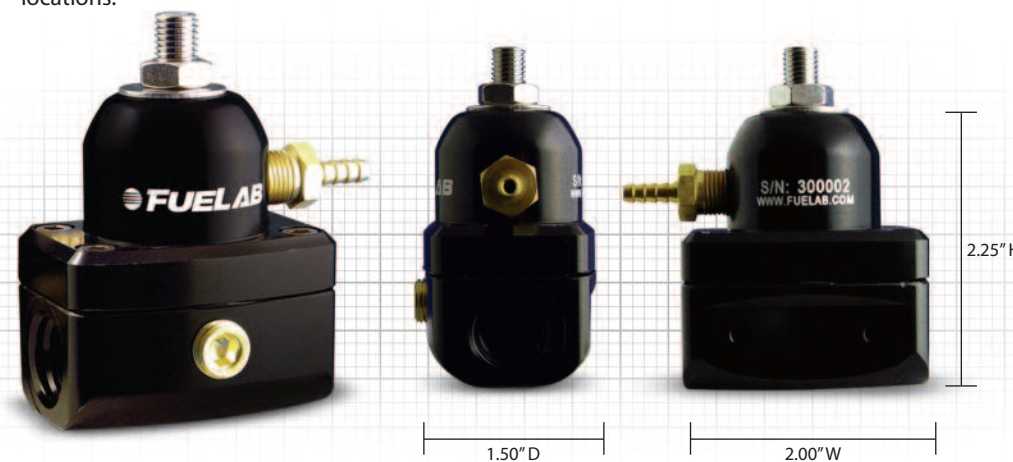

FEATURES:

- Gasoline, diesel, methanol, and ethanol fuel compatible
- Billet Aluminum with anodize per military MIL-A-8625, Type II
- Fine thread pitch for precise pressure adjustment
- Versatile mounting bracket and stainless steel hardware
- 1/8" NPT gauge port with plug for external pressure gauge
- 1/8" NPT pressure reference port with barbed fitting
- Backed by a 2-year limited warranty

PRESSURE OPTIONS:

For a custom Fuel Pressure Regulator please refer to these options and select desired (P) Pressure Range.

Pressure Range

- T** 10-25 PSID (approximate)
- E** 25-90 PSID (approximate)
- G** 90-125 PSID (approximate)

MINI DUAL INLET 535xx REGULATOR

- Two -6AN inlet ports and one -6AN return port

Product No.	Inlet	Seat Size	Pressure Range
53501-C	-6AN	Standard	EFI 25-90 PSID
53502-C-P	-6AN	Standard	Custom

EASY FIT MINI 545xx IN-LINE REGULATOR

- In-Line style makes easy installation as Universal rail mount
- -6AN inlet and -6AN return port in-line

Product No.	Inlet	Seat Size	Pressure Range
54501-C	-6AN	Standard	EFI 25-90 PSID
54502-C-P	-6AN	Standard	Custom

Fine thread pitch on adjustment hardware for precise pressure adjustment

Assortment of pressure ranges available

Lightweight fluorosilicone diaphragm assembly reduces hydraulic pressure fluctuations

Port style fittings are recommended for reduced pressure drop

-6AN return port is located on the bottom (525/545 series return port is in-line with inlet)

Hardened precision steel ball pressed into spring guide maintains consistent spring positioning for repeatable pressure settings

1/8" NPT port accommodates wide range of plumbing options Strong barbed fitting included except model 555xx

AN or military o-ring style fittings provide reliable leak-free performance

Accepts non-port style union fittings without any interference

Please Note: Fuel fittings are not included (sold separately).

FUEL PRESSURE REGULATORS



FUELAB® 555 Series Fuel Pressure Regulators are true precision instruments designed to regulate fuel. These units feature an advanced aerospace poppet design for smooth regulating capability. We've also incorporated a no-creep soft seat that's methanol and E85 compatible. Models adjustable from 1 psi up to 65 psi. Perfect for single and multi-stage nitrous applications!

555xx REGULATOR

BLOCKING STYLE
• -8AN Inlet and dual -8AN Outlet

Product No.	Inlet	Seat Size	Pressure Range
55501-C	-8AN	Large	4-12 PSI
55502-C	-8AN	Large	1-3 PSI
55503-C	-8AN	Large	10-25 PSI
55504-C	-8AN	Large	25-65 PSI

FUELAB 565 Series Fuel Pressure Regulators have all of the same great features as our 515/525 Series except for extreme capacity. With the bypass capability over 5 GPM at 5 PSI, this regulator can handle blow through carbureted applications well over 1800 H.P., and for EFI applications using belt driven fuel pumps; even further (with a flattened regulation slope). Regulator comes in four different pressure ranges covering applications between 4 and 80 PSI.

565xx REGULATOR

• Gasoline, diesel, methanol and ethanol fuel compatible
• Backed by a 2-year limited warranty

Product No.	Description	Pressure Range
56501-1	EFI Applications	25-65 PSID
56502-1	Carbureted Applications	4-12 PSID
56503-1	Throttle Body / Other	10-25 PSID
56504-1	EFI High Pressure Applications	40-80 PSID

FEATURES:

- Gasoline, diesel, methanol and ethanol fuel compatible
- Billet Aluminum with anodize per military MIL-A-8625, Type II
- Fine Thread pitch for precise pressure adjustment
- Versatile mounting bracket and stainless steel hardware
- 1/8" NPT gauge port with plug for external pressure gauge
- 1/8" NPT pressure reference port with barbed fitting
- 1.75" sized diaphragm
- Two -10AN inlets, one -10AN return port
- Backed by a 2-year limited warranty
- Available in black only



FEATURES:

- A true precision instrument to regulate fuel
- Advanced poppet design for smooth regulating capability
- Gasoline, diesel, methanol, and ethanol fuel compatible
- Methanol compatibility with a No-creep soft seat
- Billet Aluminum with anodize per military MIL-A-8625, Type II
- Fine thread pitch for precise pressure adjustment
- Versatile mounting bracket and stainless steel hardware
- 1/8" NPT gauge port with plug for external pressure gauge
- 1/8" NPT breather vent

575xx REGULATOR

BLOCKING STYLE, MINI
• -6AN Inlet and dual -6AN Outlet

Product No.	Inlet	Seat Size	Pressure Range
57501-C	-6AN	Large	4-12 PSI
57502-C	-6AN	Large	1-3 PSI
57503-C	-6AN	Large	10-25 PSI
57504-C	-6AN	Large	25-65 PSI



The 585xx Series Fuel Pressure Regulator expands the line of Blocking Style (non-bypass) Regulators like our 555xx and 575xx Series, in a Traditional 4-Port Package. The main seat assembly can be quickly exchanged in case of seat damage, such as debris. The seat assembly can be taken apart further to enable o-ring replacement of the Soft-Seat design. With Dual -10AN Inlet Ports and Four -6AN Outlet Ports (port spread allows for -8AN line size) gives the regulator ability for extremely high flow rates with a flattened curve for pressure stability through its use of a 1.5 inch diaphragm assembly.

585xx REGULATOR

BLOCKING STYLE, 4 PORT HIGH FLOW
• Dual -10AN Inlet and four -6AN Outlet

Prod. No.	Inlet	Outlet	Seat Size	Pressure Range
58501	2x -10AN	4x -6AN	Large	4-12 PSI
58502	2x -10AN	4x -6AN	Large	2-4 PSI

IN-LINE FUEL FILTERS

FUELAB® In-Line Fuel Filters keep your engine running clean. They feature male AN / 37° Flared fitting end caps, so you can attach them directly to other fuel system components*. Also featured are machined internal radii for minimal pressure drop. The compact 818 Series Fuel Filter includes a 3 inch element. For greater flow capacity and increased filtration the larger 828 Series Fuel Filter is equipped with a 5 inch element. (10 Micron / Paper elements are NOT compatible with Methanol or E85 usage).

*With AN female ports. O-ring required. Consult component manufacturer's port specifications.

FEATURES:

- Gasoline, diesel, methanol, and ethanol fuel compatible
- Billet Aluminum with anodize per military MIL-A-8625, Type II
- -6AN, -8AN, -10AN or -12AN male inlets and outlets
- Includes low profile saddle clamp mounting bracket(s)
- Replaceable or cleanable filter element
- 200 PSIG maximum pressure rating
- Backed by a 2-year limited warranty

INLET/OUTLET OPTIONS:

For a custom Fuel Filter please refer to these options and select (I) Inlet and (O) Outlet flare fitting ends.

- 6 -6AN male 37° flare fitting end
- 8 -8AN male 37° flare fitting end
- 10 -10AN male 37° flare fitting end
- 12 -12AN male 37° flare fitting end



818xx FILTER WITH 3" ELEMENT

• Compact design supports 200 GPH

Product No.	Filter Element	Inlet/Outlet
81800-C-I-O	10 micron / Paper	Custom
81801-C	10 micron / Paper	-6AN
81802-C	10 micron / Paper	-8AN
81803-C	10 micron / Paper	-10AN
81804-C	10 micron / Paper	-12AN
81810-C-I-O	40 micron / Stainless Steel	Custom
81811-C	40 micron / Stainless Steel	-6AN
81812-C	40 micron / Stainless Steel	-8AN
81813-C	40 micron / Stainless Steel	-10AN
81814-C	40 micron / Stainless Steel	-12AN
81820-C-I-O	75 micron / Stainless Steel	Custom
81821-C	75 micron / Stainless Steel	-6AN
81822-C	75 micron / Stainless Steel	-8AN
81823-C	75 micron / Stainless Steel	-10AN
81824-C	75 micron / Stainless Steel	-12AN
81830-C-I-O	6 micron / Fiberglass	Custom
81831-C	6 micron / Fiberglass	-6AN
81832-C	6 micron / Fiberglass	-8AN
81833-C	6 micron / Fiberglass	-10AN
81834-C	6 micron / Fiberglass	-12AN

▼ COLOR OPTIONS - C

Actual colors may vary.



COVER COLOR	BODY COLOR
1. Black	Black
2. Red	Clear
3. Blue	Clear
4. Purple	Clear
5. Gold	Black
6. Green	Clear

828xx FILTER WITH 5" ELEMENT

- Less pressure drop (works great as a pre-filter)
- Greater flow capacity
- Increased filtration capacity
- Reduced maintenance frequency

Product No.	Filter Element	Inlet/Outlet
82800-C-I-O	10 micron / Paper	Custom
82801-C	10 micron / Paper	-6AN
82802-C	10 micron / Paper	-8AN
82803-C	10 micron / Paper	-10AN
82804-C	10 micron / Paper	-12AN
82810-C-I-O	40 micron / Stainless Steel	Custom
82811-C	40 micron / Stainless Steel	-6AN
82812-C	40 micron / Stainless Steel	-8AN
82813-C	40 micron / Stainless Steel	-10AN
82814-C	40 micron / Stainless Steel	-12AN
82820-C-I-O	75 micron / Stainless Steel	Custom
82821-C	75 micron / Stainless Steel	-6AN
82822-C	75 micron / Stainless Steel	-8AN
82823-C	75 micron / Stainless Steel	-10AN
82824-C	75 micron / Stainless Steel	-12AN
82830-C-I-O	6 micron / Fiberglass	Custom
82831-C	6 micron / Fiberglass	-6AN
82832-C	6 micron / Fiberglass	-8AN
82833-C	6 micron / Fiberglass	-10AN
82834-C	6 micron / Fiberglass	-12AN

FILTERS AND ACCESSORIES

IN-LINE FUEL FILTERS

Models 848xx and 858xx integrated check valve and filter assemblies allow your fuel system to maintain fuel pressure after engine and pump shut down. Using a check valve in your fuel system helps prevent vapors building up in your fuel rails during engine cooling. Having a check valve will also help maintain fuel pressure during engine start-up. Our Check Valves are also Methanol, Ethanol, gasoline, and diesel fuel compatible (10 Micron / Paper elements are NOT compatible with Methanol or E85 usage). Since we integrate these two components, the check valve assembly is protected by the filter. No more scrambling to add a separate component and adapting it for your fuel system with extra fittings. Fuelab has both, all in one.

848xx

- **Integrated Check Valve Assembly with filter**
- **Helps maintain fuel pressure after shut-down**
- **Methanol and ethanol compatible**
- **3 inch element**

858xx

- **Integrated Check Valve Assembly with filter**
- **Helps maintain fuel pressure after shut-down**
- **Methanol and ethanol compatible**
- **Greater flow capacity**
- **Increased filtration capacity**
- **5 inch element**

848xx RATED UP TO **1000HP**

STANDARD FLOW INTEGRATED FILTER/CHECK VALVE

Product No.	Filter Element	Inlet/Outlet
84800-C-I-O	10 Micron / Paper	Custom *
84801-C	10 Micron / Paper	-6 AN
84802-C	10 Micron / Paper	-8 AN
84810-C-I-O	40 Micron / Stainless Steel	Custom *
84811-C	40 Micron / Stainless Steel	-6 AN
84812-C	40 Micron / Stainless Steel	-8 AN
84820-C-I-O	75 Micron / Stainless Steel	Custom *
84821-C	75 Micron / Stainless Steel	-6 AN
84822-C	75 Micron / Stainless Steel	-8 AN
84830-C-I-O	6 Micron / Fiberglass	Custom *
84831-C	6 Micron / Fiberglass	-6 AN
84832-C	6 Micron / Fiberglass	-8 AN

*The custom size 848x0 models allows for -6AN or -8AN outlet fitting size only. Inlet size can be -6AN, -8AN, -10AN or -12AN inlet sizes.

858xx RATED UP TO **2000HP**

HIGH FLOW INTEGRATED FILTER/CHECK VALVE

Product No.	Filter Element	Inlet/Outlet
85800-C-I-O	10 Micron / Paper	Custom **
85801-C	10 Micron / Paper	-8 AN
85802-C	10 Micron / Paper	-10 AN
85810-C-I-O	40 Micron / Stainless Steel	Custom **
85811-C	40 Micron / Stainless Steel	-8 AN
85812-C	40 Micron / Stainless Steel	-10 AN
85820-C-I-O	75 Micron / Stainless Steel	Custom **
85821-C	75 Micron / Stainless Steel	-8 AN
85822-C	75 Micron / Stainless Steel	-10 AN
85830-C-I-O	6 Micron / Fiberglass	Custom **
85831-C	6 Micron / Fiberglass	-8 AN
85832-C	6 Micron / Fiberglass	-10 AN

**The custom size 858x0 models allows for -8AN or -10AN outlet fitting size only. Inlet size can be -6AN, -8AN, -10AN or -12AN inlet sizes.

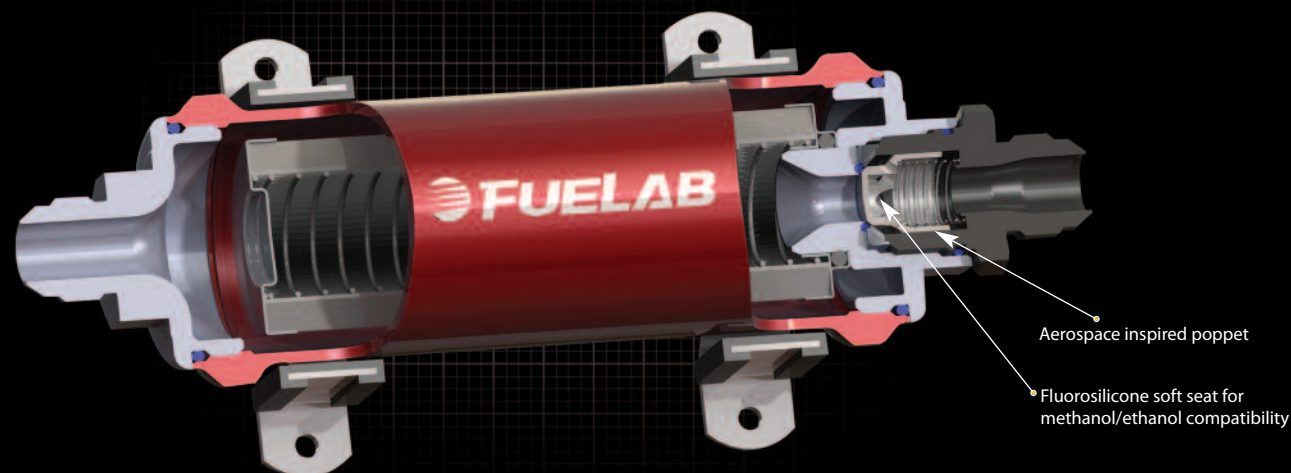

718xx REPLACEMENT ELEMENTS

10 micron / Paper Element (Cellulose)

The most economical and commonly used element. It is disposable yet provides excellent filtration. Compatible with Gasoline and Diesel only.

40 micron / Stainless Steel Element

Made for harsh racing conditions and ultimate fuel compatibility. It is cleanable and does not necessarily require replacement for maintenance.

75 micron / Stainless Steel Element

This filter element should only be used as a pre-filter for fuel pumps*. It helps prevent pump cavitation with an extremely low pressure drop.

6 micron / Micro-Fiberglass Element

Our most advanced filter element provides extra particle protection and reduces maintenance requirements with improvements in filter efficiency. This element is disposable and not to be cleaned.

*A finer micron rated element is recommended to protect injectors and carburetors downstream of fuel pump.



718xx ELEMENT REPLACEMENT FILTER

Product No.	Filter Size	Replacement Type
71801	3 Inch Element	10 micron / Paper
71802	3 Inch Element	40 micron / Stainless
71803	3 Inch Element	75 micron / Stainless
71804	3 Inch Element	6 micron / Fiberglass
71805	5 Inch Element	10 micron / Paper
71806	5 Inch Element	40 micron / Stainless
71807	5 Inch Element	75 micron / Stainless
71808	5 Inch Element	6 micron / Fiberglass

83801 RATED UP TO 1800HP

Model 83801 In-Tank Straining Filter

This 75 Micron Stainless Steel Filter can be used for straining in-tank installations. The "Sock" design allows for -10AN Pick-Up designs as well. Kit includes cleanable element and -10AN fitting adapter.



GAUGES

EFI FUEL PRESSURE GAUGES

Fuelab 1.5 Inch Fuel Pressure Gauge EFI, Range: 0-120 PSI

FEATURES:

- Black Casing
- 1.5 Inch Diameter White Face, with Black Text
- 1/8-NPT Direct Mount
- For reference use on Regulators or Fuel Rails with Gauge Ports
- Not for use in Passenger or Driver's Compartments



CARBURETED FUEL PRESSURE GAUGES

Fuelab 1.5 Inch Fuel Pressure Gauges Carbureted, Range: 0-15 PSI

FEATURES:

- Black Casing
- 1.5 Inch Diameter White Face, with Black Text
- 1/8-NPT Direct Mount
- For reference use on Regulators or Fuel Rails with Gauge Ports
- Not for use in Passenger or Driver's Compartments



715xx GAUGES EFI AND CARBURETED

Product No.	Type
71501	EFI Fuel Pressure Gauge
71502	Carbureted Fuel Pressure Gauge
71511	EFI Fuel Pressure Gauge Dual BAR/PSI Scale
71512	Carbureted Fuel Pressure Gauge Dual BAR/PSI Scale



BILLET BRACKETS

Extremely lightweight and strong racing billet brackets with steel inserts. Get the extra strength with a truly custom look.

451xx BILLET BRACKETS

MODEL SECTION TABLE

Model	Mounting	Application	No. Brackets
45101	Plate	Prodigy Fuel Pump	2
45102	Plate	Fuelab Filter	1
45103	Cage	Prodigy Fuel Pump	2
45104	Cage	Fuelab Filter	1
45105	Plate	Prodigy Fuel Pump / Fuelab Filter	2
45106	Cage	Prodigy Fuel Pump / Fuelab Filter	2

ORDERING:

Operating hours are Monday through Friday, 8:00 AM to 5:00 PM Central Time. We can be phoned Worldwide at 618.344.3300, orders can be faxed to 844.272.1189 or email us at info@fuelab.com.

TERMS:

All orders will be shipped COD or prepaid via credit card unless approved for open terms prior to ordering. We accept Visa, Master Card, American Express and Discover Card.

SHIPPING:

FOB Collinsville, IL. We ship Federal Express unless otherwise specified. Customers may authorize expedited shipments for an additional charge. Open or concealed freight damage claims must be made to the freight carrier. Damaged merchandise should not be returned to FUELAB® unless prior authorization has been obtained.

RETURNS:

Any returned merchandise must have prior approval from FUELAB® before shipping. A return material authorization number will be assigned to any return and must be clearly marked on shipment packaging. Shipping charges on returned items must be prepaid.

WARRANTY CLAIMS:

FUELAB® warrants that products sold under terms of our limited warranty will be free from defects in material and workmanship for a period of (2) years from the date of purchase to the original purchaser. Merchandise returned for inspection or repair must be sent prepaid and insured. Warranty claims must include senders name and address, an explanation of the problem, a return material authorization number, and a telephone number where the sender can be reached.

LIMITATION OF REMEDIES:

If any FUELAB® product is found to be defective under terms of our limited warranty, buyer's exclusive remedy is reimbursement of the sale price of the product. Under no circumstances, whether based on our limited warranty or otherwise, shall FUELAB® be liable for incidental, special, or consequential damages.

PRICES:

Prices are subject to change without notice.

FUELAB® fuel system components are capable of altering engine tuning and therefore may not be legal for sale or use on emission controlled motor vehicles.



1605 Eastport Plaza Drive, Suite 125 • Collinsville, IL 62234

Tel 618.344.3300 • Fax 844.272.1189 • www.fuelab.com

FUELAB